

INSTALLATION INSTRUCTION

Exploded View

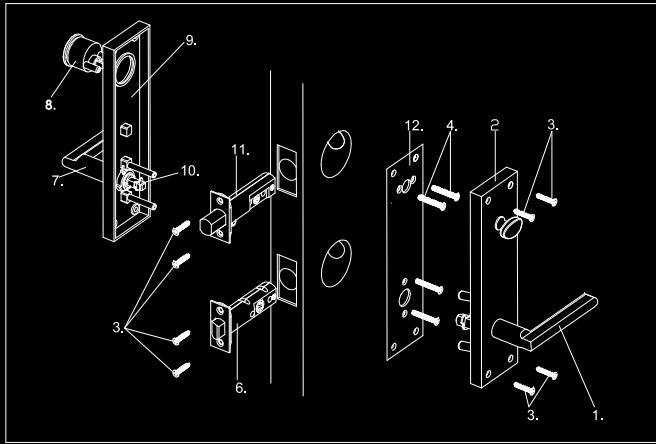

Parts Enclosed

- | | | |
|---|----------------------|----------------------|
| 1. Inside Lever (1) | 5. | 10. Spindle (1) |
| 2. Set Screws (2) | 6. Latch (1) | 11. Deadbolt (1) |
| 3. #8x1" Flat Head
Screws (4) | 7. Outside Lever (1) | 12. Adaptor B (1) |
| 4. #8-32x1-3/8" Flat Head
Screws (4) | 8. Cylinder (1) | 13. Inside Plate (1) |
| | 9. Outside Plate (1) | |

NOTE: See Strike Installation section for strike parts listing.

Door Preparation/Active Lockset

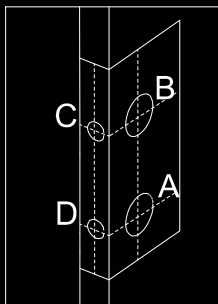

①

To position template, fold enclosed template on line and locate on door at specified height. Determine door thickness and type of Lockset to be installed. Locate and mark required holes (A, B, C, D) for drilling. As per enclosed marking template. Proceed to Step 2.

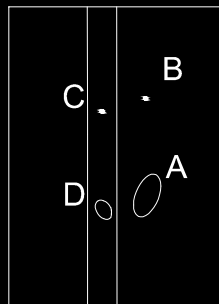

②

Drill the 2-1/8" dia. face bores (A and B) through the door and 1" dia. edge bores (C and D) 3-1/2" deep for 2-3/8" backset or 3-7/8" deep for 2-3/4" backset. The latch and deadbolt accommodate both size backsets.

Door Preparation/Active Lockset

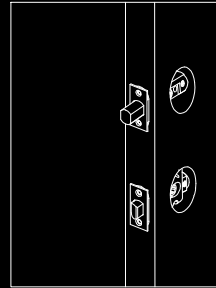

③

Insert deadbolt into edge of door. While holding faceplate parallel to edge of door, trace an outline of the faceplate onto the door edge. Mark screw hole centers and drill. Remove deadbolt and repeat the process for latch.

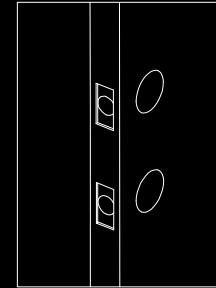

④

Chisel out area marked in step 3 to a depth of 9/64" or until faceplate is flush with door edge.

Installing Deadbolt and Latch

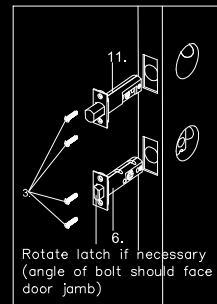

⑤

A: The latch and deadbolt will be set at 2-3/8" or 2-3/4" backset. Please make sure of backset before installation.

B: Position deadbolt and latch. Install with four #8x3/4" flat head screws provided (see diagram for proper position). Ensure deadbolt is extended through out installation procedure

Installing Trim

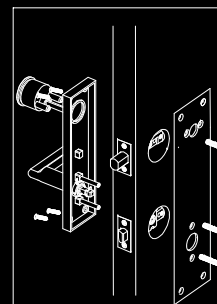

⑥

Insert the spindle into the latch while installing the exterior Trim as per the right picture, put the spindle through lever hole and then use 4 sku #8x1" screws to fix on the door.

Installing Trim

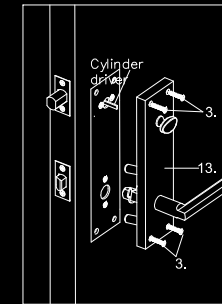

⑦

Please make the spindle the door to make it fixed into the lever and also stick to the trim. use supplied screws to fix. Mean while, install exterior leading cover in accordance with interior leading post. Use 4 #8x1" screws to fix the trim.

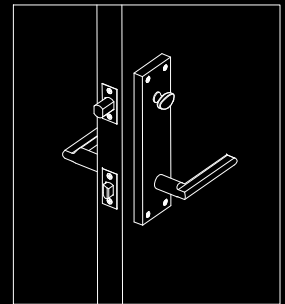

⑧

Try pulling the spindle inside the door to make it fixed into the lever and also stick to the trim. use supplied screws to fix. Mean while, install exterior leading cover in accordance with interior leading post. Use 4 #8x1" screws to fix on to the spindle.